



XF SERIES DRIPLINE : MAIN APPLICATIONS



The Intelligent Use of Water™

A low volume irrigation system typically applies water slowly, at low pressure, at or near the root zones of plant material . Whether referred to as drip, micro irrigation, or low volume , these systems feature emission devices that apply water in or liters per hour (l/ hr) as opposed to or liters per minute (l/min) of a conventional overhead spray irrigation system



Low-volume irrigation can greatly reduce or eliminate water waste while promoting healthier plant growth because you can:

- Match the amount of water applied to the specific need of each plant .
- More closely match the application rate to the soil's infiltration rate .
- Apply water directly to the root zone, reducing overspray and evaporation .



**Rain Bird's Professional
Customer Satisfaction Policy**

**XF Series Dripline offers five (5) years on product workmanship
and seven (7) years on environmental stress cracking**

Low-volume systems also reduce or eliminate runoff on walks and paved areas, and overspray onto windows, pavement, and walls. The Rain Bird Xerigation line of drip products offer a full range of water-saving choices for both turf and non-turf landscape applications.

Use of Dripline is a preferred method in many low-volume irrigation applications. Rain Bird's XF Series Dripline has in-line emitters that provide pressure compensation for precise flow control throughout the zone.

XF Series Dripline is made with advanced polymers that provide kink-resistance and reduce coil memory for easier installation.

With emitter flow rates of (2.3 l/hr and 1.6 l/hr) and emitter spacing at 0.33m, 0.40m and 0.50m, the XF Series provides a full product line to meet the needs of any application.



The Rain Bird XF Series of Dripline products consists of:

- XFD Dripline for on-surface applications
- XFS Dripline with Copper for sub-surface applications



XFD Dripline



XFS Dripline

BENEFITS OF DRIPLINE IRRIGATION

Dripline irrigation can greatly reduce or eliminate water waste while promoting healthier plant growth for the following reasons:

- Match the water application to the specific needs of each plant .
- More precisely match the application rate to the soil's infiltration rate .
- Apply water directly to the root zone to reduce overspray and evaporation .
- A properly designed and installed Dripline irrigation system can be over 90% efficient .

There are many advantages of Dripline irrigation that can provide solutions for difficult-to-irrigate landscape areas:



- Narrow turf areas
- Curved narrow landscape areas
- Sloped areas
- Sub-surface turf irrigation applications
- Parking lot islands
- Steep sloped areas
- ...

Other benefits of on-surface or sub-surface Drip Irrigation:

- Eliminate runoff on walks and paved areas
- Prevent overspray onto windows, walls and fences
- Increase watering uniformity
- Reduce susceptibility to vandalism
- Promote healthy plant growth

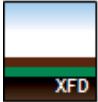

APPLICATION OVERVIEW

	 ON-SURFACE	 SUB-SURFACE
Product	XFDDripline	XFS Dripline
Sloped Areas	X	X
Shrub & Ground Cover Beds	X	X
ContainerPlanters	X	X
High Traffic Areas	X	X
Curved Landscapes	X	X
Narrow Landscaped Areas	X	X
Areas of Vandalism	X	X
Median / Parking Islands Shrub & ground Cover	X	X
High Wind Conditions	X	X
Turf (grass)		X
Sub-Surface Applications		X
NarrowTurfAreas		X
Large Turf Areas /Athletic Fields		X
Median / Parking Islands Turf		X

XFD DRIPLINE
On- surface



- Greater flexibility
- Longer lateral runs
- Exceptional durability

XFS DRIPLINE
Sub-surface



- Copper Shield™ Technology
- Trifluralin-free emitter protection
- Exceptional durability

Best on surface applications : Where is it used ?



ON-SURFACE

- Shrub and groundcover beds
- Seasonal color beds
- Curved landscapes
- Small confined areas
- Areas where overspray is undesirable such as buildings, windows, and fences
- Narrow landscapes
- Areas affected by wind and evaporation



Seasonal color beds



Narrow landscapes



ON-SURFACE

#1 Narrow Planting Bed Next to Structure



Solution

XF Series Dripline

Advantages

- Up to 60% water savings
- No overspray damage to structures, fences or windows
- XF Dripline is easy to install resulting in labor savings





ON-SURFACE

#2 Narrow Planting Bed /Divider: Combination Applications



Solution

XF Series Dripline

Advantages

- Up to 60% water savings to zero wind loss
- No overspray damage to structures, fences or windows
- XF Dripline is easy to install resulting in labor savings



ON-SURFACE

#3 Slopes or Combination Applications



Solution

XF Series Dripline

Advantages

Up to 60% water savings to zero wind loss

No runoff=reduced liability in high traffic areas

- The design of the Dripline system should account for slopes on the site since runoff may occur at low points
- Slopes less than 3% do not require special design considerations
- Slopes greater than 3% should increase the Dripline spacing by 25% in the bottom 1/3 of the zone
- Dripline should run perpendicular (across) the slope when possible





ON-SURFACE

#4 Street Medians: Combination Applications



Solution

XF Dripline

Advantages

Up to 60% water savings

XF Series Dripline is easy to install for labor savings

No overspray damage to structures , fences or windows

No runoff=reduced liability in high traffic areas

Low maintenance results in labor savings



SUB-SURFACE

Best sub surface applications : Where is it used ?

- Narrow turf areas
- Large turf areas
- Sub-surface shrub and ground cover areas
- Near buildings
- Adjacent to parking lots
- Small, confined areas
- Athletic Fields
- Green roofs
- ...



BENEFITS OF SUB-SURFACE DRIP IRRIGATION

- Increased efficiency
- Lower water use
- Elimination of overspray
- Resistant to vandalism
- Healthy plant growth
- Increased watering uniformity
- No damage to fences or trees
- Less water run-off into sewers & drains
- Lower maintenance
- Increased time for field or turf usage
- No wind issues
- Less evaporative loss



Narrow strips or next to roadways



SUB-SURFACE

S
3
2
0

#1 Areas Where Overspray Must Be Avoided



Car dealerships or parking lots



Adjacent to buildings or hardscapes

Solution
XFS Dripline

Advantages

It is a challenge to avoid overspray in narrow turf areas along a roadway, narrow parking strip, or car dealership . These examples show how subsurface drip irrigation can avoid overspray by irrigating from below grade



SUB-SURFACE

2 Adjust for trees



The tree is on a separate zone and there is full separation between the tree and the turf grass .



Although the tree and turf grass are on the same zone , the buried Dripline should be placed far enough away from the trunk so that tree roots do not push the Dripline to the surface .

Solution

XFS Dripline

Advantages

Trees. With any irrigation strategy, it is recommended that trees planted in grassy areas should be irrigated on a different zone than the turf grass . This is particularly true with subsurface drip because over time, tree roots could push the buried subsurface drip lines up to the surface .

Also, trees are more valuable than grass, so if the zone for the grass area needs to be turned off to reduce water consumption, then a separate zone for the trees can still be operated to maintain health .



SUB-SURFACE

#3 Adjust for curved edges



Solution

XFS Dripline

Advantages

Curved Edges. Rain Bird XFS Dripline with Copper Shield™ is flexible to follow curves that are 7 .6 cm in radius and larger . When there are curved shapes in the landscape, avoid designing Dripline rows that follow the curved edges of the landscape . Instead, lay out as many straight lines as possible to simplify the installation, then fill in missed areas with additional straight lines if possible.



SUB-SURFACE

4 Green Roofs

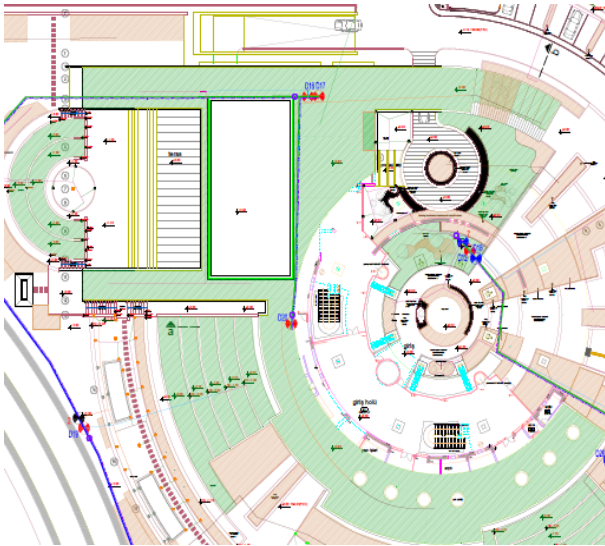

Solution

XFS Dripline

Advantages

Invisible irrigation solution for roof gardens. The solution offers a precise combination of nutrients and water that are delivered directly to the plant's roots zone.

Thin root layer – Rain Bird XFS delivers water and nutrients directly to the plant's roots zone in a precise and efficient manner.

Winds - Roof tops are generally more windy, so using sub-surface dripline , making it more resistant to high winds.

Low pressure - Water pressure at the top of apartment buildings is difficult to regulate for irrigation systems. XFS solution is both low pressure and low flow systems , easier to the manage.

Weight load –Short drip irrigation cycles to prevent overweight caused by excess water on the roof.

➤ **Self cleaning and root prevention** – Minimum maintenance –No extra cost

The Intelligent Use of Water™

At Rain Bird®, we believe it is our responsibility to develop products and technologies that use water efficiently. Our commitment also extends to education, training and services for our industry and our communities.

The need to conserve water has never been greater. We want to do even more, and with your help, we can. Visit www.rainbird.com for more information about The Intelligent Use of Water™.

**Rain Bird Europe SNC**

900, rue Ampère, B.P. 72000
13792 Aix en Provence Cedex 3
FRANCE
Tel: (33) 4 42 24 44 61
Fax: (33) 4 42 24 24 72
rbe@rainbird.eu - www.rainbird.eu

Rain Bird France SNC

900, rue Ampère, B.P. 72000
13792 Aix en Provence Cedex 3
FRANCE
Tel: (33) 4 42 24 44 61
Fax: (33) 4 42 24 24 72
rbf@rainbird.eu - www.rainbird.fr

Rain Bird Sverige AB

C/O MATRISEN
Nordenskiöldsgatan 6
211 34 Malmö
SWEDEN
Tel: (46) 42 25 04 80
rbs@rainbird.eu - www.rainbird.se

Rain Bird Iberica S.A.

Polígono Ind. Pinares Llanos
c/ Carpinteros, 12, 2ºC
28670 Villaviciosa de Odón, Madrid
ESPAÑA
Tel: (34) 91 632 48 10
Fax: (34) 91 632 46 45
rbib@rainbird.eu - www.rainbird.es
portugal@rainbird.eu - www.rainbird.pt

Rain Bird Deutschland GmbH

Königstraße 10c
70173 Stuttgart
Deutschland
Tel: +49 (0)711 222 54 158 Fax: +49
(0)711 222 54 200 rbd@rainbird.eu

Rain Bird Türkiye

Çamlık Mh. Dinç Sokak Sk. No.4 D:59-60
34774 Ümraniye, İstanbul
Türkiye
Tel: (90) 216 443 75 23
Fax: (90) 216 461 74 52
rbt@rainbird.eu - www.rainbird.com.tr

www.rainbird.eu

RBE15TE05